

vtech[®]

User's Manual

Lil' Critters Musical Dreams Mobile™

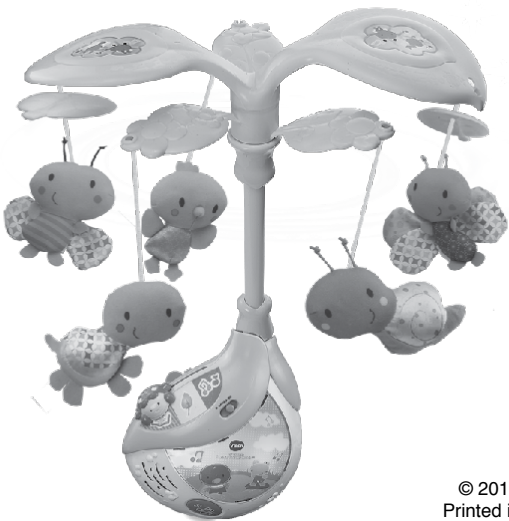

© 2015 VTech
Printed in China
91-002376-021 US

Dear Parent,

*Ever notice the look on your baby's face when they learn something new through their own discovery? These self-accomplished moments are a parent's greatest reward. To help fulfill them, VTech® created the **Infant Learning**® series of toys.*

*These unique interactive learning toys directly respond to what children do naturally – play! Using innovative technology, these toys react to baby's interactions, making each play experience fun and unique as they learn age-appropriate concepts like first words, numbers, shapes, colors and music. More importantly, VTech®'s **Infant Learning**® toys develop baby's mental and physical abilities by inspiring, engaging and teaching.*

At VTech®, we know that a child has the ability to do great things. That's why all of our electronic learning products are uniquely designed to develop a child's mind and allow them to learn to the best of their ability. We thank you for trusting VTech® with the important job of helping your child learn and grow!

Sincerely,

Your friends at VTech®

To learn more about VTech® toys, visit vtechkids.com

INTRODUCTION

Thank you for purchasing the **VTech® Lil' Critters Musical Dreams Mobile™** learning toy!

The **VTech® Lil' Critters Musical Dreams Mobile™** plays 4 soothing sung songs, 40 relaxing melodies and peaceful nature sounds while the activity panel emits a calming glow. The leaves spin gently, while the five brightly colored dangling animals turn round and round with the music to help lull baby to sleep. The adjustable timer allows parents to select the time that best suits baby's needs.

DANGLING PLUSH
ANIMALS

TURNING LEAF MOBILE

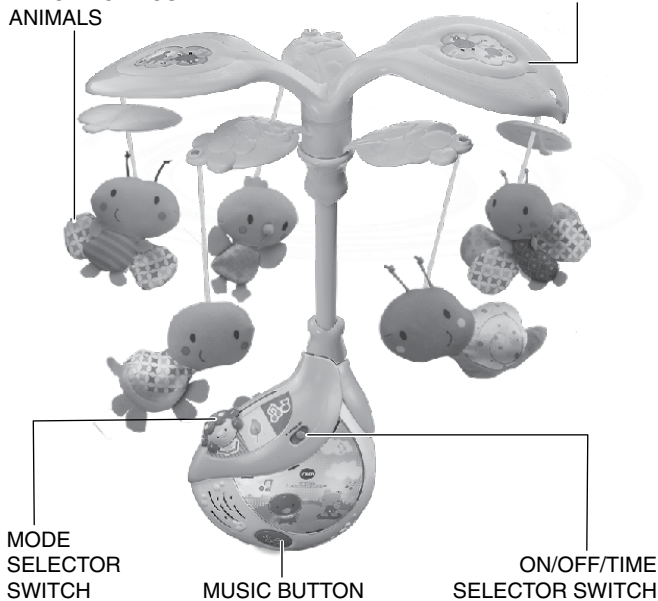

MODE
SELECTOR
SWITCH

MUSIC BUTTON

ON/OFF/TIME
SELECTOR SWITCH

INCLUDED IN THIS PACKAGE

- One VTech® Lil' Critters Musical Dreams Mobile™ activity panel
- One turning leaf mobile
- One support post
- Five dangling plush animals
- One instruction manual
- Two crib attachment straps

WARNING: All packing materials, such as tape, plastic sheets, packaging locks and tags are not part of this toy, and should be discarded for your child's safety.

ATTENTION: Pour la sécurité de votre enfant, débarrassez-vous de tous les produits d'emballage tels que rubans adhésifs, feuilles de plastique, attaches et étiquettes. Ils ne font pas partie du jouet.

NOTE: Please keep user's manual as it contains important information.

GETTING STARTED

BATTERY INSTALLATION

1. Make sure the unit is turned **OFF**.
2. Locate the battery cover on the back of the unit. Use a coin or a screwdriver to loosen the screw.
3. Install 4 new 'AA' (AM-3/LR6) batteries following the diagram inside the battery box.
4. Replace the battery cover and tighten the screw to secure the battery cover.

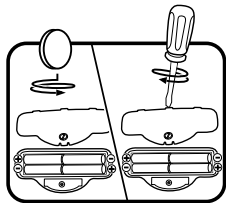

BATTERY NOTICE

- Use new alkaline batteries for maximum performance.
- Use only batteries of the same or equivalent type as recommended.
- Do not mix different types of batteries: alkaline, standard (carbon-zinc) or rechargeable (Ni-Cd, Ni-MH), or new and used batteries.
- Do not use damaged batteries.
- Insert batteries with the correct polarity.
- Do not short-circuit the battery terminals.
- Remove exhausted batteries from the toy.
- Remove batteries during long periods of non-use.
- Do not dispose of batteries in fire.
- Do not charge non-rechargeable batteries.
- Remove rechargeable batteries from the toy before charging (if removable).
- Rechargeable batteries are only to be charged under adult supervision.

DEMO TAG

The demo tag should be removed automatically when the product is taken out of the packaging. If the demo tag is still in position, please remove the plastic strip from the back of the product before placing in the crib. This will activate normal play.

With the **Lil' Critters Musical Dreams Mobile™**, safety comes first.

- Keep the mobile out of baby's reach. To avoid entanglement injuries, please remove the mobile portion from the crib once baby begins sitting or pushing up on all fours.
- Age range of mobile - Birth to 5 months
- The crib mobile is intended for visual stimulation and is not intended to be grasped by a child.

- Always attach all provided fasteners (strings, straps, clamps, etc.) tightly to the crib according to the instructions. Check frequently. Attach only to cribs with sturdy rails and spindles. Do not attach to play pens with mesh walls.
- Do not add additional strings or straps to attach to a crib.
- To ensure your child's safety, the product should be assembled by an adult.
- Make sure the crib attachment straps are out of your child's reach.
- When removing the **VTech® Lil' Critters Musical Dreams Mobile™** from the crib, please detach the crib attachment straps from the unit, and keep the straps out of your child's reach.

ASSEMBLY INSTRUCTIONS

1. Take the cord with both a dangling animal and leaf piece, thread the cord up through the bottom of the hole on the large leaf. Set the knot so it rests on the smaller hole on the leaf.

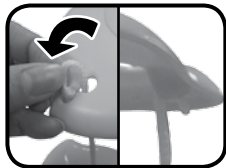

2. Take the cord with just a dangling animal piece and slide the cord through the slit in the leaf. Set the knot so it rests securely in the hole on the leaf.



3. Attach the turning leaf piece into the recessed slot on top of the mobile support post. You will hear a click when the post is inserted correctly.



4. Insert the bottom of the mobile support post into the recessed slot on the top of the activity panel. You will hear a click when the post is inserted correctly.

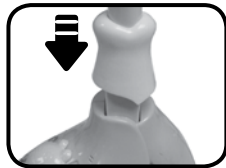

5. Place the unit in the crib against the top rail. Press the blue button and slide the crib attachment strap up through the slot behind the button. Repeat with the second crib attachment strap.



6. Tie the cord securely around the nearest spindle. Pull slightly on the unit to make sure the straps have been securely fastened. The unit should be tight against the crib rail. Check the unit regularly to ensure it is secure.

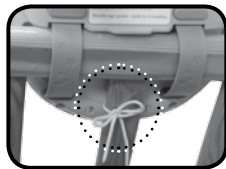

7. To detach the mobile from the activity panel, press the small blue button on the back of the activity panel and pull up on the mobile support post.



8. To detach the crib attachment straps, open the battery door, then slide the switches next to the straps toward the centre of the activity panel and pull the crib attachment straps free.

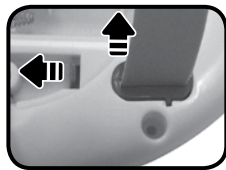

PRODUCT FEATURES

1. ON/OFF/TIME SELECTOR SWITCH

To turn the unit **ON**, slide the **ON/OFF/TIME SELECTOR SWITCH** to the 10, 20 or 30 minute time setting. To turn the unit **OFF**, slide the **ON/OFF/TIME SELECTOR SWITCH** to the **OFF**(●) position.



2. MODE SELECTOR SWITCH

Slide the **MODE SELECTOR SWITCH** to choose one of the three play modes.



3. MOBILE/LIGHT PLAY SWITCH

Slide the **MOBILE/LIGHT PLAY SWITCH** to select the desired setting. (📖) plays lights and spins the mobile, (📖) spins the mobile with no lights, (💡) plays lights only.



4. VOLUME CONTROL

Press the volume control buttons to choose the desired volume. Press the right button to increase the volume and press the left button to decrease the volume.



5. SOUND SENSOR

The **VTech® Lii' Critters Musical Dreams Mobile™** is equipped with a special sound sensor. Once the selected time setting has ended, the unit will automatically power-down. The sensor will reactivate the program when it detects baby's crying.

6. AUTOMATIC SHUT-OFF

To preserve battery life, the **VTech® Lil' Critters Musical Dreams Mobile™** will automatically power-down after the selected time has ended. The unit can be turned on again by pressing the music button or when the sound sensor detects baby's crying.

ACTIVITIES

1. Slide the **on/off/time selector switch** to the desired time setting. You will hear a welcoming response related to the selected mode.
2. Slide the **mode selector switch** to choose a mode of play. In the story mode (📖), you will hear a variety of sung nursery rhymes followed by children's melodies. The soothing mode (🌿) plays a variety of soft melodies and nature sounds. The melody mode (🎵) plays a variety of soothing melodies.
3. Press the **music button** to change the melody, song or sound.

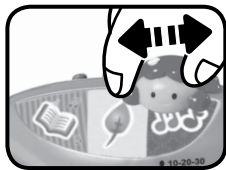

MELODY LIST

1. Bear Went Over the Mountain
2. Baa Baa Black Sheep
3. Little Miss Muffet
4. Mary, Mary Quite Contrary
5. Three Little Kittens
6. Jack and Jill
7. Here We Go Round the Mulberry Bush
8. Sailing, Sailing
9. My Bonnie Lies Over the Ocean
10. Teddy Bears' Picnic
11. Three Blind Mice
12. This Old Man
13. Rock-a-bye Baby
14. Hush Little Baby
15. Old Grey Mare
16. Sur le pont d'Avingnon
17. Humpty Dumpty
18. Ta Ra Ra Boom De Ay
19. Listen to the Mockingbird
20. Cockles & Mussels
21. The Swan - Saint-Saëns
22. Air - Bach
23. Kinderscene - Schumann
24. All Through the Night
25. Lullaby - Brahms
26. Morning (Peer Gynt Suite) - Grieg

27. All the Pretty Little Horses
28. Sweet and Low
29. Spring Song - Mendelssohn
30. Cradle Song
31. Dance of the Sugar Plum Fairy - Tchaikovsky
32. Serenade - Haydn
33. Minuet - Boccherini
34. Nocturne in Eb No.2 Op. 9 - Chopin
35. Prelude in A - Chopin
36. Clair de Lune - Debussy
37. Moonlight Sonata - Beethoven
38. Sleeping Beauty Waltz - Tchaikovsky
39. Water Music No 2 in D Alla Hornpipe - Handel
40. Klipp Klope Galopp - Strauss

SUNG SONG LYRICS

Song 1

Beautiful dreamer, wake unto me,
Starlight and dewdrops are waiting thee.

Song 2

Sleep, baby, sleep,
Your father tends the sheep.
Your mother shakes the dreamland tree,
And from it fall sweet dreams for thee.
Sleep, baby, sleep

Song 3

Good night, baby.
Good night, baby.
Good night, baby.
It's time to go to sleep.

Song 4

Twinkle, twinkle, little star,
How I wonder what you are.
Up above the world so high,
Like a diamond in the sky.
Twinkle, twinkle, little star,
How I wonder what you are.

CARE & MAINTENANCE

1. Keep the unit clean by wiping with a slightly damp cloth.
2. Keep the unit out of direct sunlight and away from any direct heat source.
3. Remove the batteries when the unit is not in use for an extended period of time.
4. Do not drop the unit on hard surfaces and do not expose the unit to moisture or water.

TROUBLESHOOTING

If for some reason the program/activity stops working or malfunctions, please follow these steps:

1. Please turn the unit **OFF**.
2. Interrupt the power supply by removing the batteries.
3. Let the unit stand for a few minutes, then replace the batteries.
4. Turn the unit **ON**. The unit should now be ready to play again.
5. If the product still does not work, replace with an entire set of new batteries.

If the problem persists, please call our Consumer Services Department at 1-800-521-2010 in the U.S. or 1-877-352-8697 in Canada, and a service representative will be happy to help you.

For information on this product's warranty, please call VTech® at 1-800-521-2010 in the U.S. or 1-877-352-8697 in Canada.

IMPORTANT NOTE:

Creating and developing **Infant Learning** products is accompanied by a responsibility that we at **VTech®** take very seriously. We make every effort to ensure the accuracy of the information, which forms the value of our products. However, errors sometimes can occur. It is important for you to know that we stand behind our products and encourage you to call our Consumer Services Department at 1-800-521-2010 in the U.S. or 1-877-352-8697 in Canada, with any problems and/or suggestions that you might have. A service representative will be happy to help you.

Note:

This equipment has been tested and found to comply with the limits for a Class B digital device, pursuant to Part 15 of the FCC Rules. These limits are designed to provide reasonable protection against harmful interference in a residential installation. This equipment generates, uses and can radiate radio frequency energy and, if not installed and used in accordance with the instructions, may cause harmful interference to radio communications. However, there is no guarantee that interference will not occur in a particular installation.

If this equipment does cause harmful interference to radio or television reception, which can be determined by turning the equipment off and on, the user is encouraged to try to correct the interference by one or more of the following measures:

- Reorient or relocate the receiving antenna.
- Increase the separation between the equipment and receiver.
- Connect the equipment into an outlet on a circuit different from that to which the receiver is connected.
- Consult the dealer or an experienced radio/TV technician for help.

Caution : changes or modifications not expressly approved by the party responsible for compliance could void the user's authority to operate the equipment.



PRODUCT WARRANTY

This Warranty is applicable only to the original purchaser, is non-transferable and applies only to "VTech" products or parts. This product is covered by a 3-month Warranty from the original purchase date, under normal use and service, against defective workmanship and materials. This Warranty does not apply to (a) consumable parts, such as batteries; (b) cosmetic damage, including but not limited to scratches and dents; (c) damage caused by use with non-VTech products; (d) damage caused by accident, misuse, unreasonable use, immersion in water, neglect, abuse, battery leakage, or improper installation, improper service, or other external causes; (e) damage caused by operating the product outside the permitted or intended uses described by VTech in the owner's manual; (f) a product or part that has been modified (g) defects caused by normal wear and tear or otherwise due to the normal aging of the product; or (h) if any VTech serial number has been removed or defaced.

Prior to returning a product for any reason, please notify the VTech Consumer Services Department, by sending an email to vtechkids@vtechkids.com or calling 1-800-521-2010. If the service representative is unable to resolve the issue, you will be provided instructions on how to return the product and have it replaced under Warranty. Return of the product under Warranty must adhere to the following rules:

If VTech believes that there may be a defect in the materials or workmanship of the product and can confirm the purchase data and location of the product, we will at our discretion replace the product with a new unit or product of comparable value. A replacement product or parts assumes the remaining Warranty of the original product or 30 days from the date of replacement, whichever provides longer coverage.

THIS WARRANTY AND THE REMEDIES SET FORTH ABOVE ARE EXCLUSIVE AND IN LIEU OF ALL OTHER WARRANTIES, REMEDIES AND CONDITIONS, WHETHER ORAL, WRITTEN, STATUTORY, EXPRESS OR IMPLIED. IF VTECH CANNOT LAWFULLY DISCLAIM STATUTORY OR IMPLIED WARRANTIES THEN TO THE EXTENT PERMITTED BY LAW, ALL SUCH WARRANTIES SHALL BE LIMITED TO THE DURATION OF THE EXPRESS WARRANTY AND TO THE REPLACEMENT SERVICE AS DETERMINED BY VTECH IN ITS SOLE DISCRETION.

To the extent permitted by law, VTech will not be responsible for direct, special, incidental or consequential damages resulting from any breach of Warranty.

This Warranty is not intended to persons or entities outside the United States of America. Any disputes resulting from this Warranty shall be subject to the final and conclusive determination of VTech.